

Cost of Overseeding For a Single Family Home



Ashley Arens (Intern)
Richard Bond (Mentor, City of Tempe Water Utilities Department)
Marcia Nation (Mentor, Julie Ann Wrigley Global Institute of Sustainability)



What is overseeding?

Overseeding is the practice of applying cool season grass (Poa sp) on top of your existing Bermuda grass (Cynodon dactylon). The process requires you to dethatch (scalp) your lawn in early September in preparation for a proper seedbed. To allow proper germination heavy watering is required of about two to three times a day for the first few weeks. Homeowners overseed to continue to have a green lawn in the cool winter months.

Issues of overseeding

- Additional winter turf maintenance
- Unnecessary water use
- Additional sewer fees based on cities winter sewer calculations
- Only value is aesthetic
- Air pollution
- Overall a heavy cost for the homeowner

Methods

I used Maricopa County Assessor's office parcel map to collect a sample group of sixty single family homes with lot sizes between 6,000-9,000 square feet. Of the homes I chose, thirty did overseed and thirty did not. A two year billing history was retrieved from the City of Tempe water billing system. Then their consumption history was placed on excel sheets where an average was formulated.

Findings

Average Monthly Charges

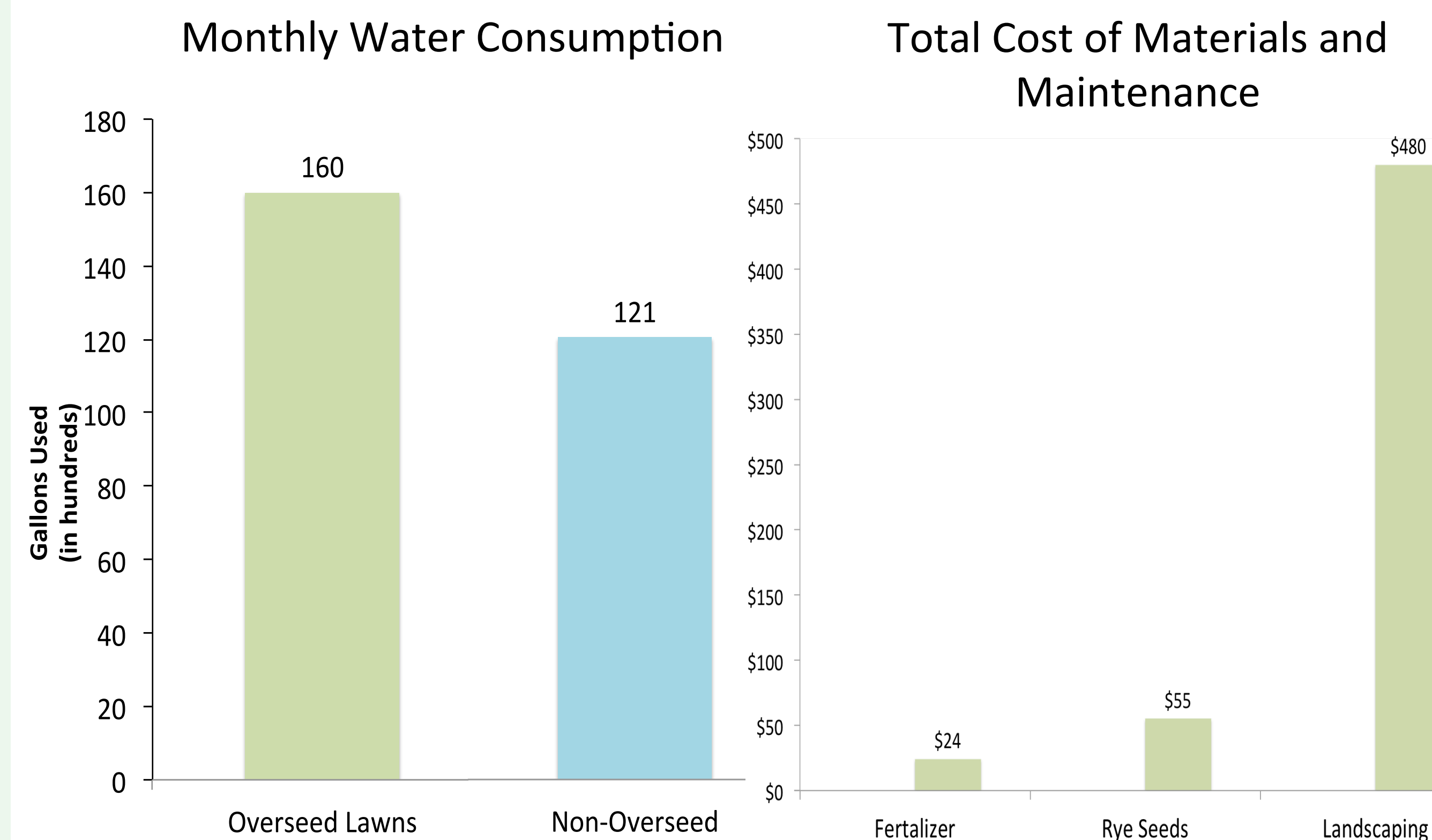
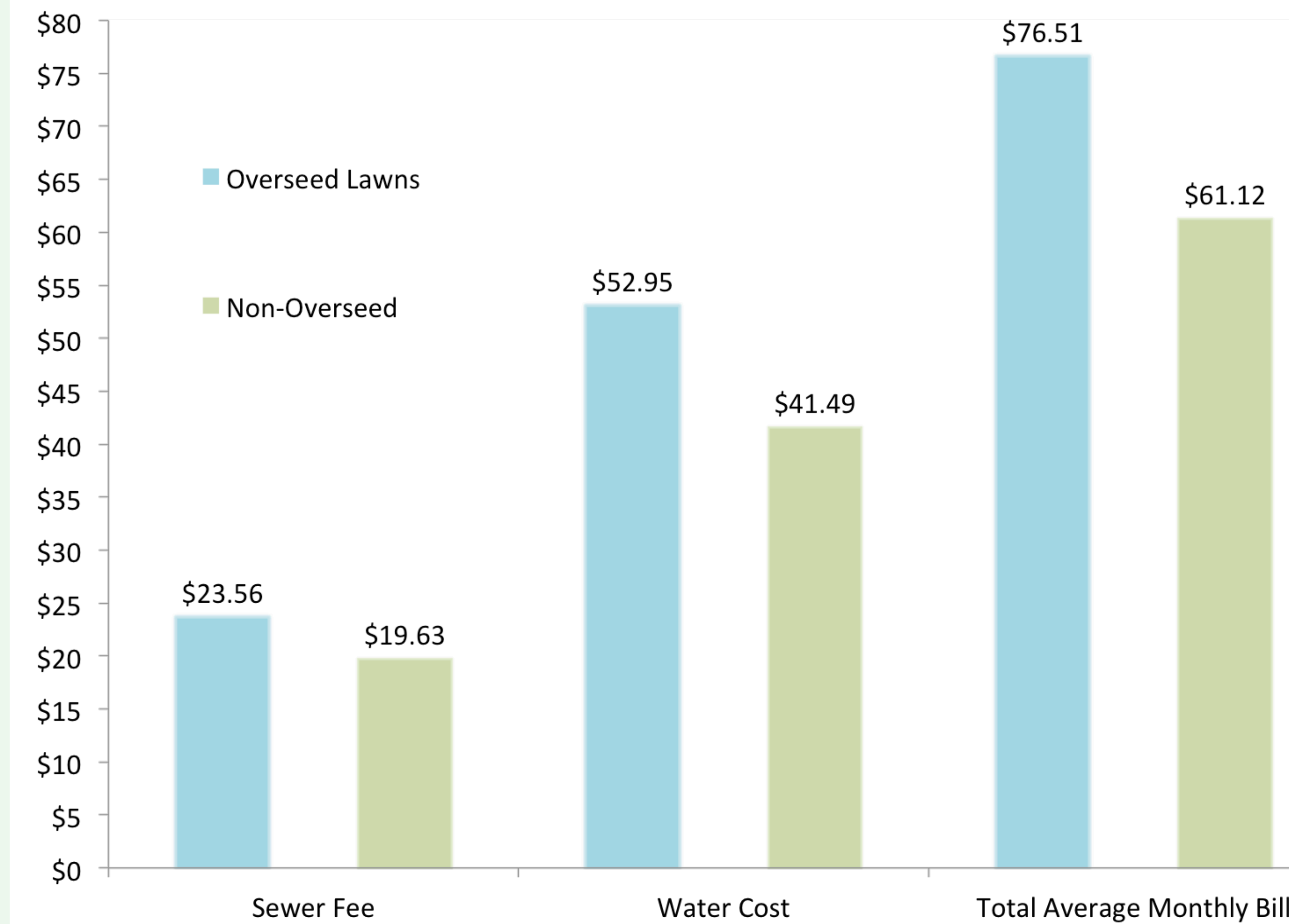

Water Cost: \$184.68
Materials Cost: \$79
Seasonal Maintenance: \$480
Water Consumption: 3,900 gallons

The practice of overseeding cost a homeowner a total of \$743.68 more annually. While consuming 3,900 more gallons of water.

Alternatives to turf

Overseeding is an entirely aesthetic based practice that could contribute to a future water shortage in Arizona. Research shows an average cost savings of \$743.68 for maintenance, materials, and sewer fees that are prorated in winter months. Outdoor water usage accounts for up to 75% of a households water expenses, and homeowners should consider switching over to xeriscape. This landscape design requires little to no irrigation. Desert native plants reduce air pollutants generated from the maintenance of turf, as well as conserve water. The city of Tempe offers a rebate program for homeowners of \$.25 cents per square foot for the total area converted from turf to desert landscape.

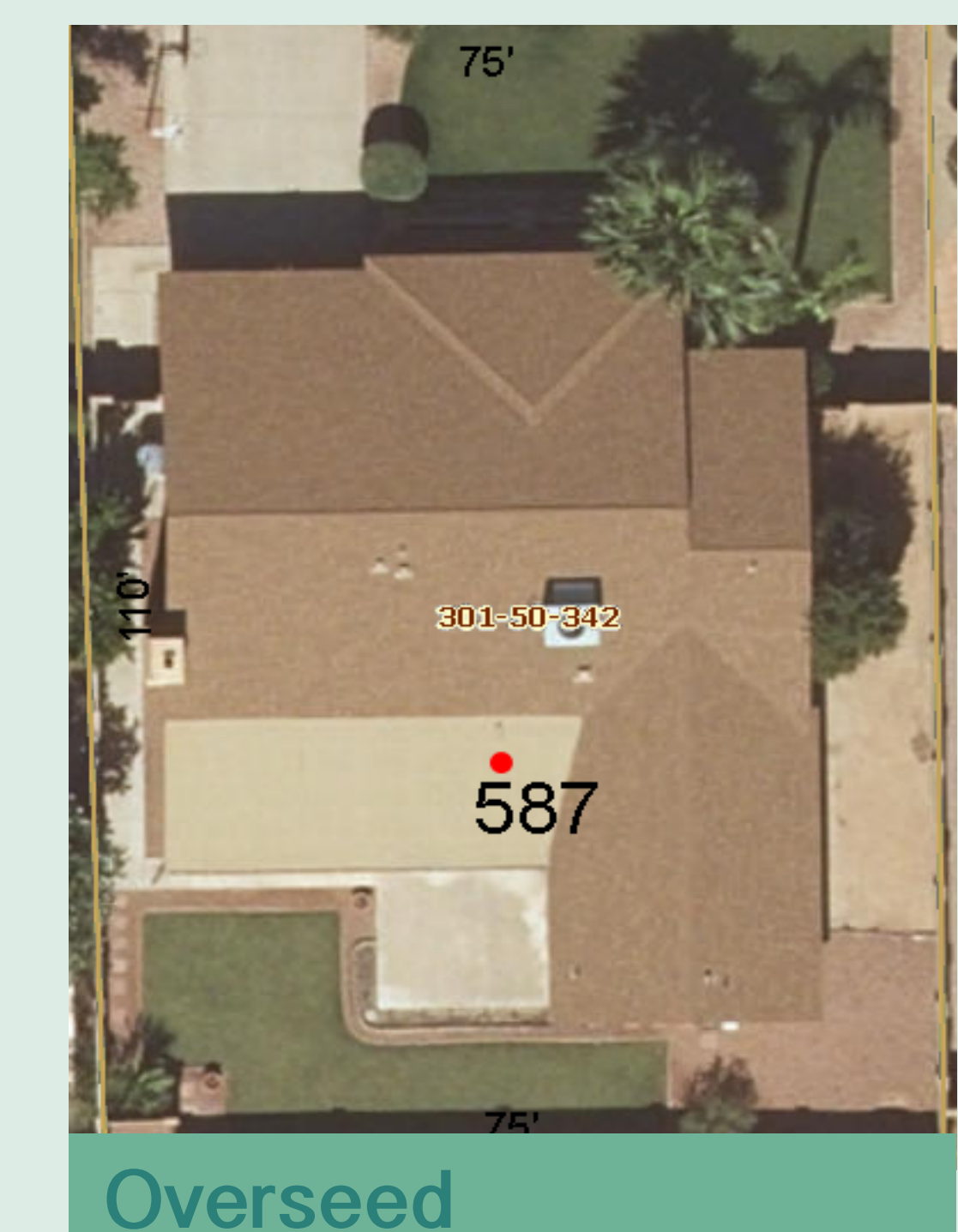

Acknowledgements

This material is based upon work supported by the National Science Foundation under Grant No. SES-0951366 Decision Center for a Desert City II: Urban Climate Adaptation (DCDC). Any opinions, findings and conclusions or recommendation expressed in this material are those of the author(s) and do not necessarily reflect the views of the National Science Foundation (NSF). City of Tempe.